

AUDITOR

130648



Heavy Duty Variable Speed Shaft & Ferrule Prepping Center

[Http://www.golfmechanix.com](http://www.golfmechanix.com)
E-mail: Sales@Golfmechanix.com

Description of Parts

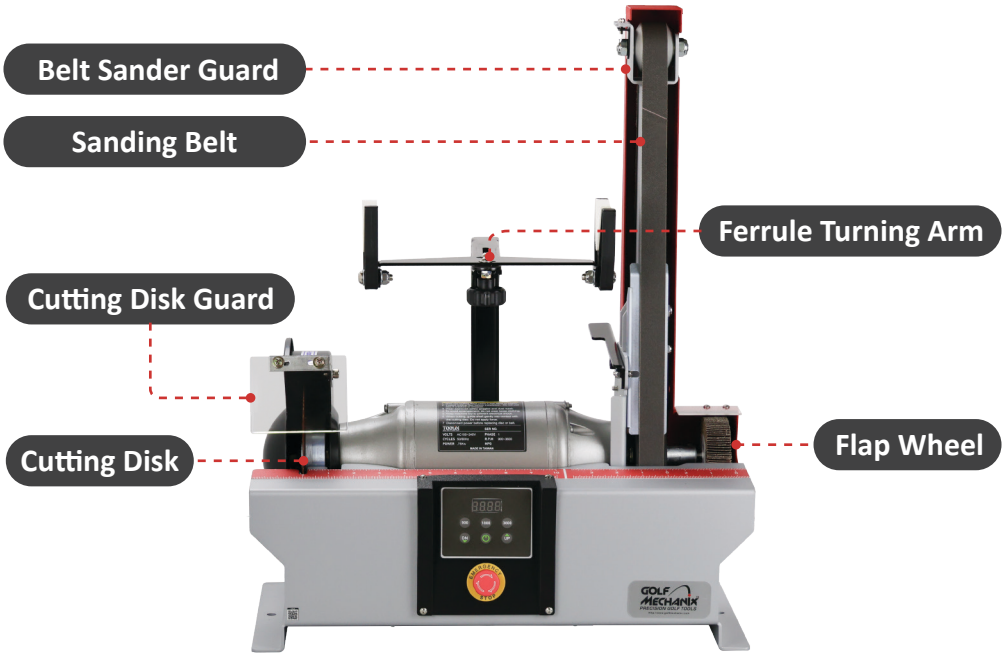

Control Panel



Setup

The unit must be placed on a flat and sturdy surface. It is recommended that the unit is bolted down to the mounting surface. Bolts do not come included with the unit

Once the unit is placed, plug the cord into an electrical socket. The unit runs universally on 100~240VAC.

Dust extraction vents are built into the guards. If you have a shop vacuum available, it is recommended that it is connected.

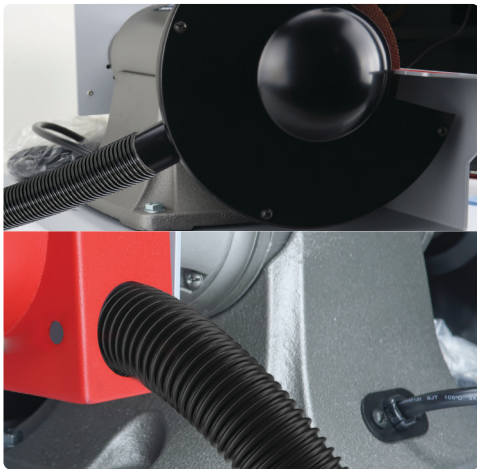

Operation

1. Check that the E. Stop button is not actuated. If it is, reset it by turning it clock-wise.
2. Turn the unit on by pressing the power button. The RPM readout will light up in a few seconds.
3. Select one of the preset RPMs by clicking on it. The unit will start and slowly pick up speed.

4. Adjust the RPM by either selecting another preset or using the speed up/down buttons.

5. Turn off the unit by pressing the power button. In the case on an emergency, press the E.stop button to stop the unit.

Safety



- Wear a dust mask
- Wear safety goggles
- Ear plugs should be worn if the unit is being used for a prolonged time.

Maintenance

The surface of the unit should be wiped down regularly to prevent dust build up.

The interior of the guards should also be cleaned out regularly, even if a shop vacuum is used.

The following pages cover how to replace the sanding belt, flap wheel and cutting disk.

WARNING

Maintenance procedure will typically require the guards be removed. Before doing so, make sure the unit is disconnected from its power source!



Removing the Belt Guard

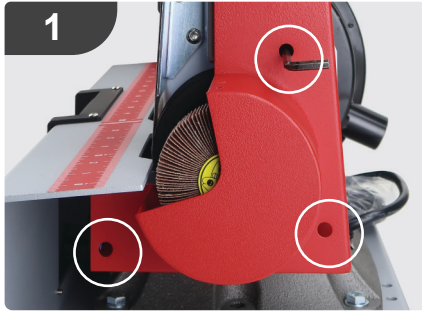

▲ Remove the belt guard by first loosening the 3 screws circled.



▲ The screws are hidden beneath the guard. Reach through the openings with the included hex key to loosen the screws.



▲ Once the screws are loosened the guard can be removed as shown. To Replace the guard, simply put the guard back and tighten the screws.

Replacing the Sanding Belt

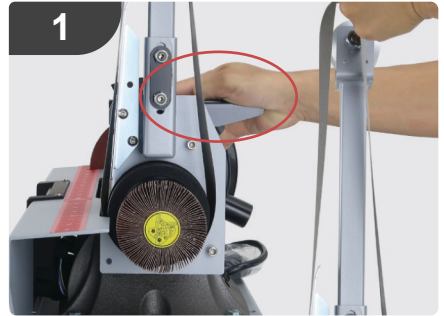

▲ Begin with the belt guard removed. Press down on the handle with one hand: this will release the belt. With your free hand, remove the belt.



▲ Press down on the handle with one hand and with your free hand install the new belt. Check if the belt is installed correct side facing out.



▲ Manually rotate the belt a few times to make sure it's installed properly. Adjust the belt as needed.



Replacing the Flap Wheel



▲ Begin with the belt guard removed. Using a hex key, loosen the screw securing the sanding wheel. Once the screw is loosened, you can pull out the wheel and replace it with a new one. Tighten the screw after replacing.

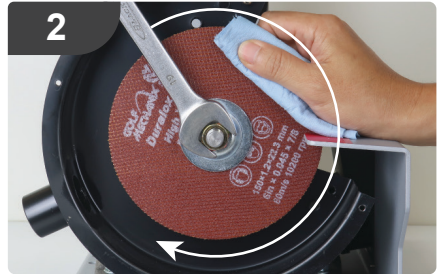

▲ Using a size 19 wrench, secure the nut. Pnch the cutting wheel tightly using a piece of fabric then turn the wrench clockwise.

Make sure the disk does not slip and that you do not bend the disk side ways. Bending the disk sideways can cause the disk to shatter!

Replacing the Cut off wheel



▲ Remove the cutting disk guard by unscrewing the 4 screws shown.



▲ Remove the nut and shim then remove the cutting disk. Replace the disk and secure it in place using the shim and nut then re-install the cutting disk guard.



Flap Wheel and Silicon Carbide coated composite fiber brush

SP-G050202-80

SP-G050202-120

SP-G0502-01



Replacement Cut off wheel High Yield

SP-G0403-04HY-P10

Apply the protective felt pads

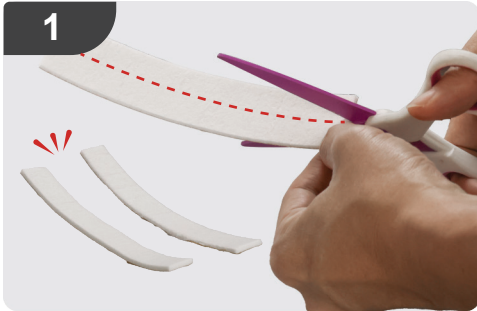

▲ Cut the protective felt in half.



▲ Measure briefly and trim off any excess.



▲ Apply the protective felt along the groove and press gently to secure.

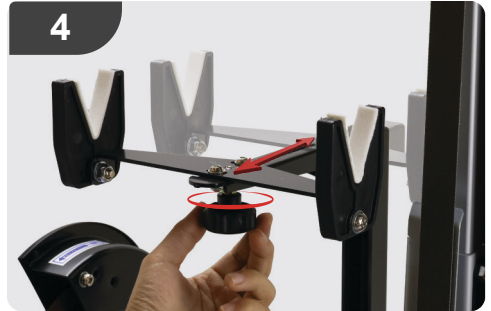

▲ Loosen the adjustment knob to allow for forward/backward movement and slight lateral rotation. Once positioned, tighten the knob to secure.

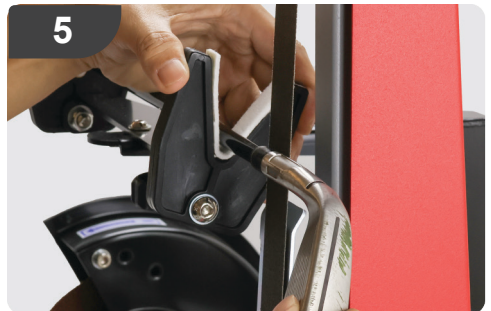

▲ Please prioritize safety and control your pressure when sanding the rubber sleeve. If you encounter any issues during use, please feel free to contact us. Thank you!